



Aravali View
Premium Hill Homes



Fully
loaded
apartments

Architect
**Hafeez
Contractor**

Landscape Design by
**LSG INC.
USA**



Awarded in 2014 as
**Asia's Best
Real Estate
Property**
to Look Out For -
Official Tabulator
E&Y™

MAPSKO 
MOUNT VILLE

Sector 79, Gurgaon

HRERA registered 328 of 2017 dated 23/10/2017

Bring Home the Mountains



Regd. Off.

52, North Avenue Road, Punjabi Bagh (West), New Delhi - 110026
T.: +91-11-42467410-20-30-40 F.: +91-1142467409

Gurgaon Off.:

125, First Floor, Vipul Agora, M G Road, Gurgaon - 122002
T.: +91-124-4250610-20-30-40 F.: +91-124-4250650

www.mapskogroup.com

Get Inspired everyday with Aravali's splendour

The Aravali range is one of the world's oldest mountain ranges. Its northern end continues into Haryana and ends in Delhi at Raisina Hill as its last extension. Despite erosion over time the hills are no less than a source of eternal beauty and a matter of everyday inspiration for beholders. Its panoramic view, greenery and healthy environmental effects make it a special feature of Mount Ville.





Designed for Delightful living

Hafeez Contractor is India's most celebrated architect. He is known for creating marvels but, in creating the blueprint of Mount Ville, his genius has tried to compete with the height and beauty of overlooking hill range. Whether exterior or interior, every inch of architectural magic, strewn in apartments and terrace homes totaling 756 apartments decorating 8 high-rise towers, is amazingly impeccable and ideal for royal living.

Spread over 16.5 acres of land | Elevated complex on green belt | Apartments ranging from 1490 sq. ft. to 2650 sq. ft. Terrace homes ranging from 1620 sq. ft. to 2710 sq.ft





*A perfect
compliment to
majestic Aravalis*

The artistic rendition of abundance of green, pathways, amphitheatre, lawns, and most sustainable ratio of open space versus built-up space make Mount Ville a unique treat of urban living. The breathtaking landscaping plan has been masterfully prepared by world's leading landscape architectures – LSG Inc, USA.

**Terrace lawn | Pergola seating | Senior citizen area | Stage & seating area | Artwork / Sculpture
Children's play area**



Living Room

This is an artistic impression - Mount Ville



Dining Room



Spacious Lobby



Master Bedroom

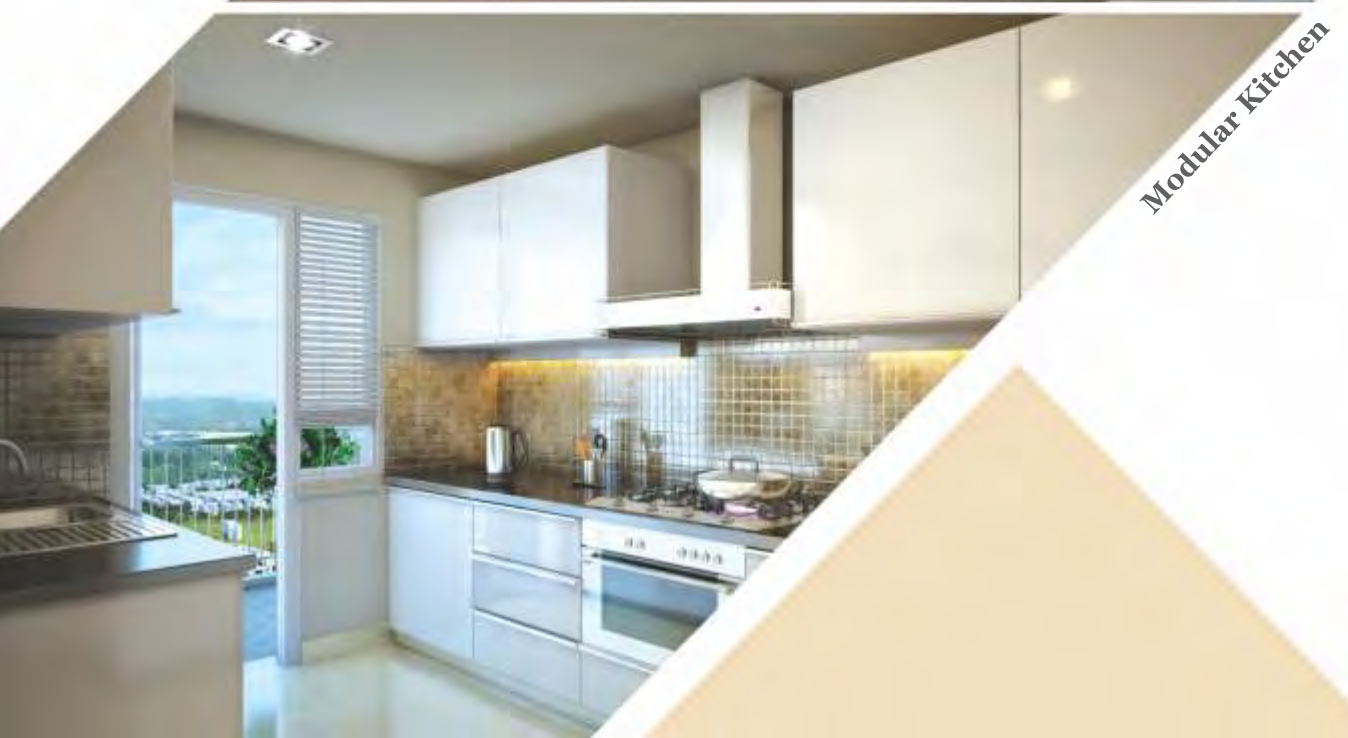

Modular Kitchen

Pampering four-walls to inspire all

Inundated with sunlight and cross currents of refreshing breeze, the spacious Drawing room is ever ready to welcome you and your guests. The sprawling and cosy bedrooms give the cherished confinement with promise of desired comfort. Whether the solitary room of children's study, ideally located kitchen for the lady of the house, or balconies that offer mountain view while you relax over a cup of tea, every apartment of Mount Ville adds value to inspired living.

**3-4 Bedrooms premium hill view apartments
Modular kitchen with chimney and hub |
Spacious Balconies**



*A paradise for
fitness & Leisure
enthusiasts*

Health is wealth. With the rising awareness, observing a regimen of sports has rather become a part of lifestyle. Some play a racquet game, some ball sport and some simply jog or walk. Mount Ville facilitates high standard of sports facilities within its campus where luxurious living is amply buttressed by a wide range of recreational features.

**Gymnasium | Tennis court | Skating rink
Outdoor fitness node | Badminton court**



Different strokes of swimming

Swimming and water sports make an integral part of today's inspired lifestyle. Going for a spirited dive and splashing a few strokes in the blue waters of swimming pool is joy for children and a rejuvenating work out for seniors. Keeping in mind different choices of different age group, Mount Ville has a variety of well-built pools; not merely for sake of them, but to ensure that luxury is not watered down even if it's about water bodies.

Adult pool | Children's pool | Interactive water feature | Water feature



This is an artistic impression - Mount Ville



Jogging Track



Seating Area



Water Features

Gazebo in Park



Dazzling Legends for enriching lifestyle

Entry | Exit | Water Feature | Pergola Screening at Ramp | Tennis and Multiple Purpose Court | Drop-Off Points | Gazebo | Children's Play Area | Adult Pool | Pergola Water Feature | Green Terraced Lawn | Senior Citizens Seating Space | Stage and Seating Area | Multipurpose Court | Amphitheatre Seating | Multipurpose Lawn Space | Jogging Track | Skating Court | Outdoor Fitness Space



This is an artistic impression - Mount Ville

LEGENDS

- Entry
- Exit
- Water Feature
- Pergola Screening at Ramp
- Tennis and Multiple Purpose Court
- Drop-Off Points
- Gazebo
- Children's Play Area
- Adult Pool
- Pergola Water Feature
- Green Terraced Lawn
- Senior Citizens Seating Space
- Stage and Seating Area
- Multipurpose Court
- Amphitheatre Seating
- Multipurpose Lawn Space
- Jogging Track
- Skating Court
- Outdoor Fitness Space
- Cricket Pitch
- Childrens Pool
- Trellis Feature
- Club with Amenities

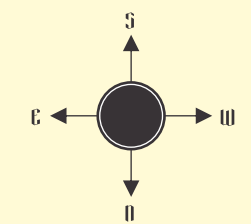

Site Plan

Note: Visual representations shown in this brochure are purely conceptual. All building plans, specifications, layout plans etc. are tentative and subject to variation & modification by the company or the competent authorities sanctioning plans. Brand names appearing in the brochure are for artwork purposes only.
1sq.m. = 10.763 sq.ft.

Specifications

AIR CONDITIONING	Split ACs of Daikin or equivalent in all Bedrooms and Living room	DOORS	Internal Seasoned hardwood frames with moulded skin shutters
ENTRANCE LOBBY	Air-conditioned double height entrance Lobby with 3 high-speed elevators	Entrance Door Teak veneered & polished shutter	External Doors & Windows Branded UPVC
LIVING, DINING & LOBBY / PASSAGE	Floor Italian/Imported marble Walls Plastic paint with pleasing shades and POP	TOILETS (Except Servant's Toilet)	Walls Ceramic tiles till 7'0" height Floor Anti-skid Ceramic Tiles Counter Granite Fittings / Fixtures • Mirror • CP fittings of Grohe / Kohler or equivalent • Premium brand of WC & wash basin.
BEDROOMS	Floor Premium quality laminated wooden flooring in all bedrooms Walls Plastic paint with pleasing shades and POP Fitting/ Fixtures Wardrobes	ELECTRICAL	• Modular switches of Legrand or equivalent • Copper electrical wiring throughout in the concealed conduit with provisions for Light point, Power point, TV & Phone Sockets with protective MCBs • Power backup to be provided in each apartment minimum 5 KVA mandatory
BALCONIES	Floor Terrazzo / Ceramic Tiles Walls Permanent Paint Finish	SECURITY SYSTEM/ FIRE FIGHTING SYSTEM	3-Tier security system, Gated community and CCTV in Common areas.
KITCHEN	Walls Ceramic Tiles up to 2 feet above counter & Plastic paint in balance area Floor Antiskid Ceramic Tiles Counter Granite Fittings / Fixtures • Modular kitchen with chimney and hob • Gas Pipeline • CP fittings of Grohe / Kohler or equivalent • SS Single bowl Sink with drain board	CLUB FACILITY	Swimming Pool, Kids Pool, Steam, Sauna, Spa, Gymnasium, Basketball Court, Tennis Court, Table Tennis, Pool Table, Kids Play Area, and Multipurpose Hall
SERVANT ROOM	Floor Terrazzo / Ceramic Tiles Walls Acrylic emulsion paint.	FACADE	Texture Finish

Floor Plans

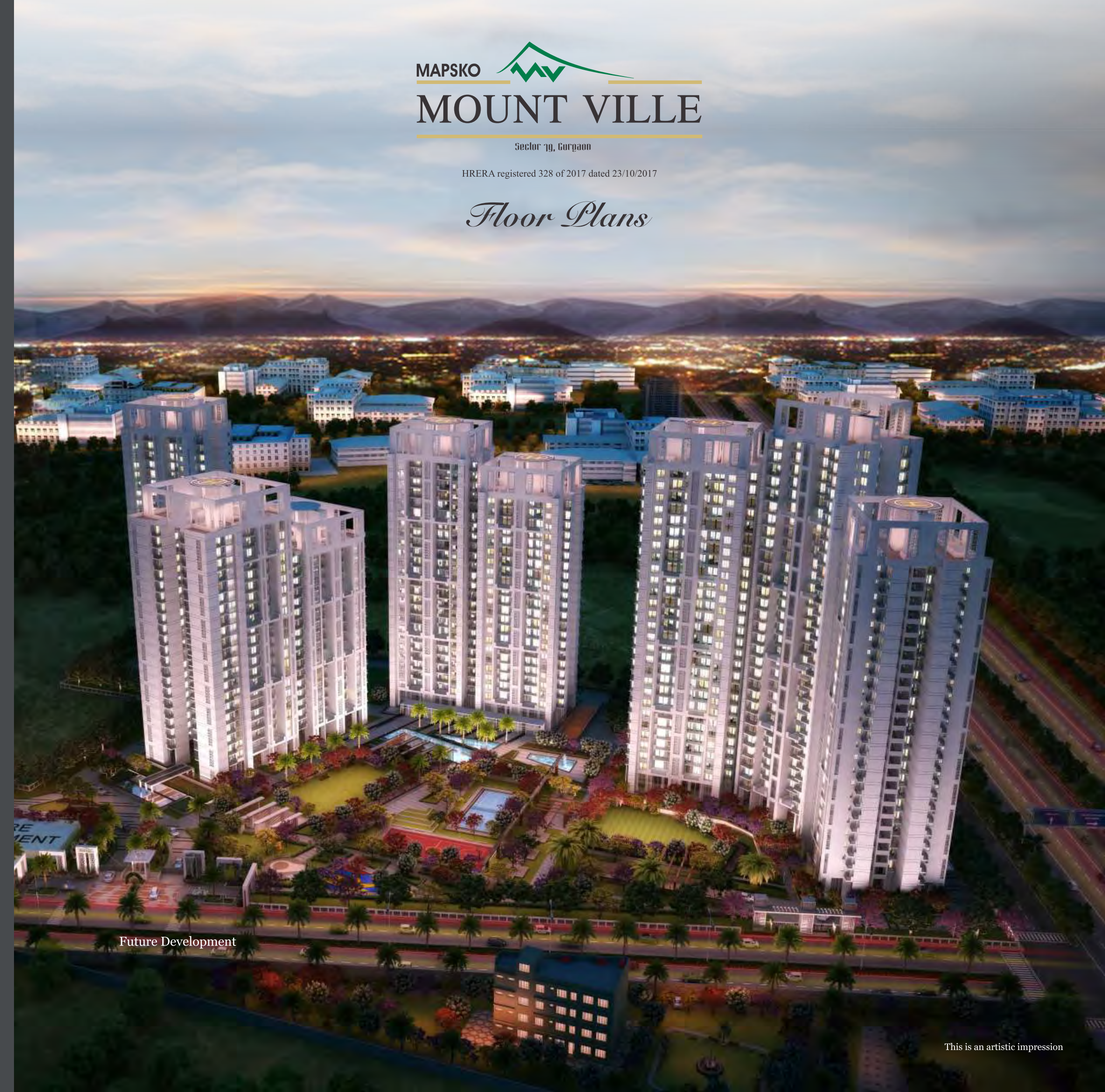

Future Development

Windows to

Luxury

Awarded in 2014 as
Asia's Best
Real Estate
Property
to Look Out For -
High Rise
Green Homes



Double Height
AC Entrance
Lobby on ground
at every tower



Near
3 Sprawling
Golf Courses



Beautiful
Landscape
Designed by
LSG INC.
USA

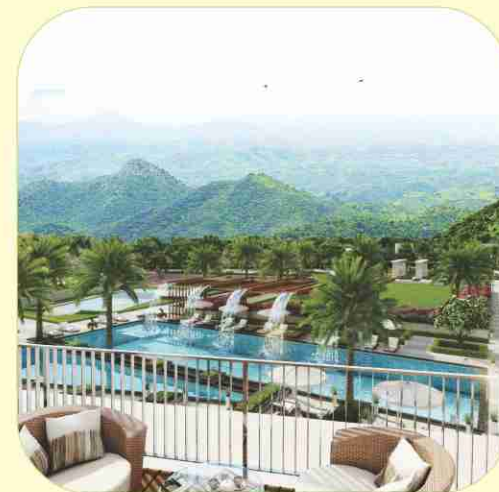

Exemplary
Architecture
by
Hafeez
Contractor

Double Height
Stilt for more
Greenery &
Open Space



Exclusive
Terrace Homes



Fully AC
Apartments

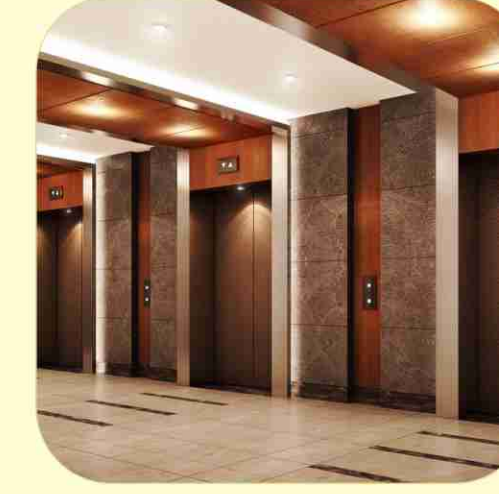

3 Lifts in
Each Tower

Imported
Marbles in
Living Area



Stylish
Modular
Wardrobe For
Chic Robes



Modular
Kitchen with
Chimney &
Gas Pipe Line



Attractive
Location
Feasibility



- Just 2 min. drive away from NH-8
- 5 min drive from Golf Course Extn. Road / Sohna Road
- 2 min. drive from SPR

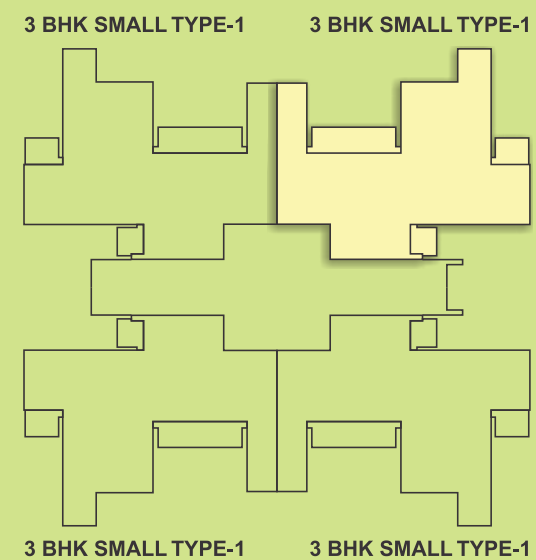

TYPE 1 -

Reference Area: 1490 sq. ft. 3BHK + 3T
 Carpet Area: 862.18 ~ 865.52 sq.ft.
 Balcony Area: 136.48 ~ 141.54 sq.ft.
 For Towers C,D,E,F and H

Note: Visual representations shown in this brochure are purely conceptual. All building plans, specifications, layout plans etc. are tentative and subject to variation & modification by the company or the competent authorities sanctioning plans. Brand names appearing in the brochure are for artwork purposes only.

1sq.m. = 10.763 sq.ft.

Type 1 -

Reference Area: 1620 sq. ft. 3BHK + 3T + TERRACE
 Carpet Area: 862.18 ~ 865.52 sq.ft.
 Balcony Area: 280.6 ~ 285.88 sq.ft.
 Towers C,D,E,F and H

Note: Visual representations shown in this brochure are purely conceptual. All building plans, specifications, layout plans etc. are tentative and subject to variation & modification by the company or the competent authorities sanctioning plans. Brand names appearing in the brochure are for artwork purposes only.

1sq.m. = 10.763 sq.ft.

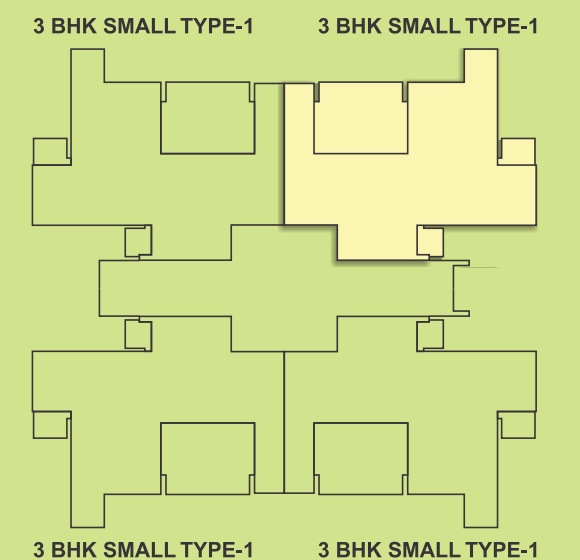

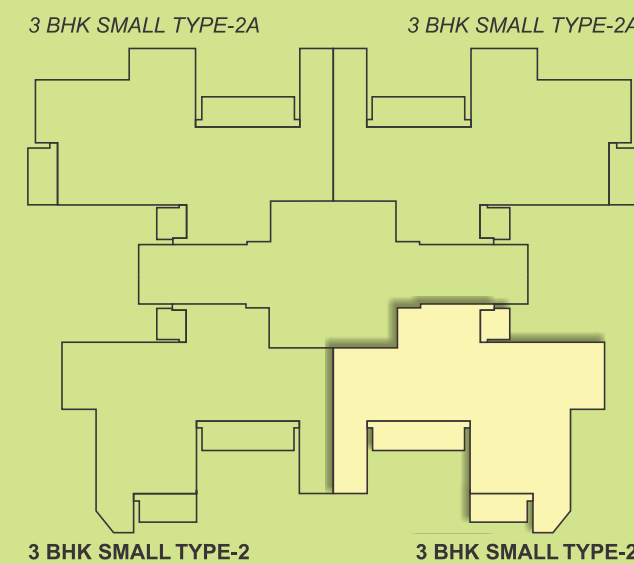

TYPE 2 -

Reference Area: 1510 sq. ft. 3BHK + 3T
 Carpet Area: 862.18 sq.ft
 Balcony Area: 158.87 sq.ft
 For Tower G Front Units

Note: Visual representations shown in this brochure are purely conceptual. All building plans, specifications, layout plans etc. are tentative and subject to variation & modification by the company or the competent authorities sanctioning plans. Brand names appearing in the brochure are for artwork purposes only.
 1sq.m. = 10.763 sq.ft.

TYPE 2 -

Reference Area: 1620 sq. ft. 3BHK + 3T + Terrace
 Carpet Area: 862.18 sq.ft.
 Balcony Area: 285.99 sq.ft.
 Tower G Front Unit

Note: Visual representations shown in this brochure are purely conceptual. All building plans, specifications, layout plans etc. are tentative and subject to variation & modification by the company or the competent authorities sanctioning plans. Brand names appearing in the brochure are for artwork purposes only.
 1sq.m. = 10.763 sq.ft.

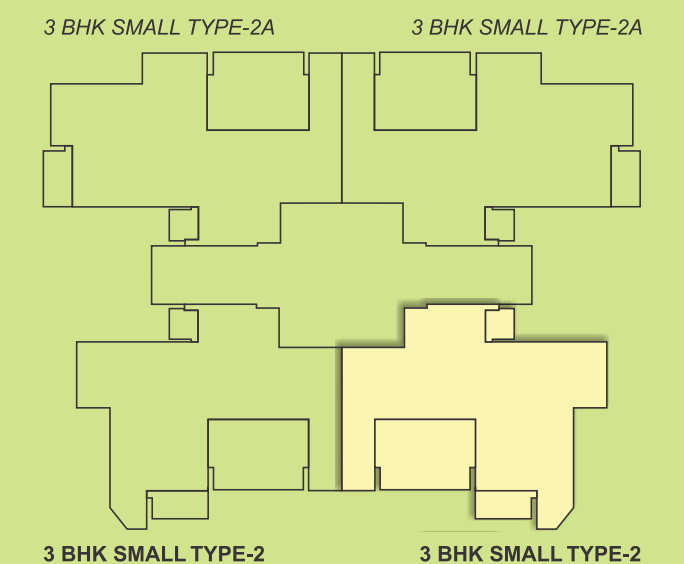

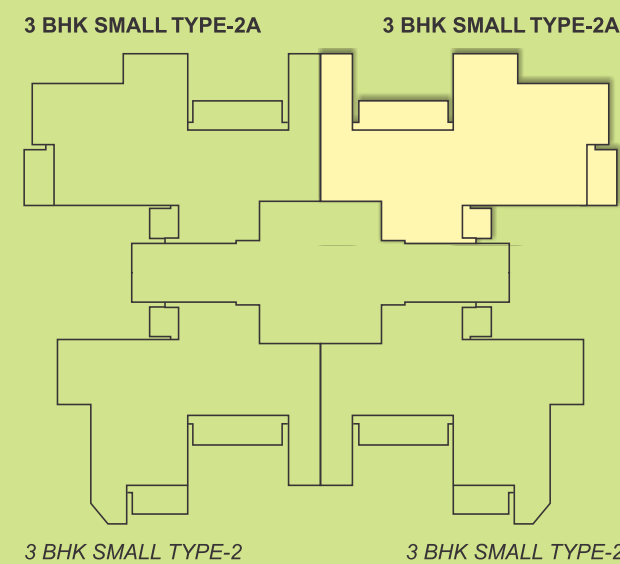

TYPE 2A -
 Reference Area: 1510 sq. ft. 3BHK + 3T
 Carpet Area: 867.24 sq.ft.
 Balcony Area: 158.87 sq.ft.
 Tower G Back Units

Note: Visual representations shown in this brochure are purely conceptual. All building plans, specifications, layout plans etc. are tentative and subject to variation & modification by the company or the competent authorities sanctioning plans. Brand names appearing in the brochure are for artwork purposes only.
 1sq.m. = 10.763 sq.ft.

TYPE 2A -
 Reference Area: 1620 sq. ft. 3BHK + 3T + TERRACE
 Carpet Area: 867.24 sq.ft.
 Balcony Area: 303.1 sq.ft.
 Tower G Back Units

Note: Visual representations shown in this brochure are purely conceptual. All building plans, specifications, layout plans etc. are tentative and subject to variation & modification by the company or the competent authorities sanctioning plans. Brand names appearing in the brochure are for artwork purposes only.
 1sq.m. = 10.763 sq.ft.

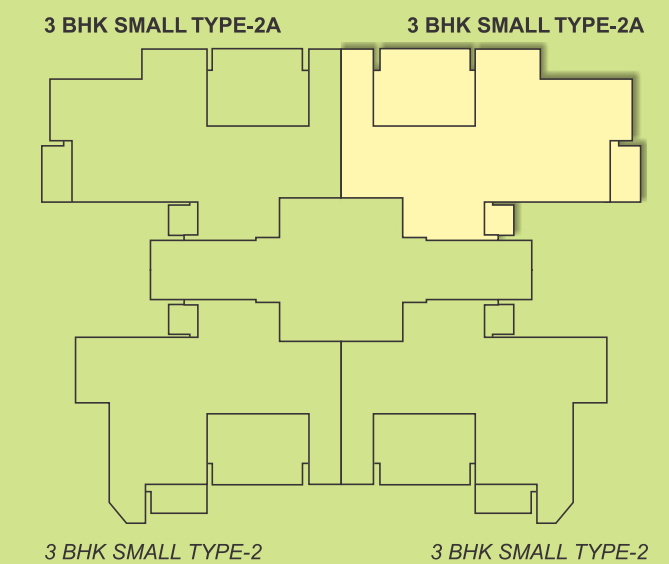

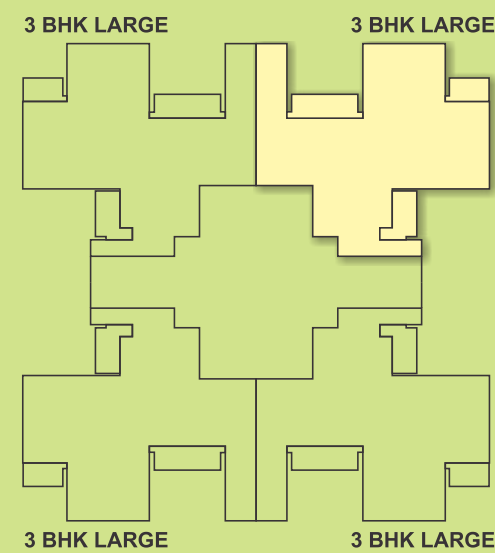

Reference Area: 1815 sq. ft. 3BHK + 3T + SR
 Carpet Area: 1071.33 sq.ft. ~ 1074.23 sq. ft
 Balcony Area: 167.27 sq.ft. ~ 167.70 sq.ft.
 Tower B and A (1 and 4 Units)

Note: Visual representations shown in this brochure are purely conceptual. All building plans, specifications, layout plans etc. are tentative and subject to variation & modification by the company or the competent authorities sanctioning plans. Brand names appearing in the brochure are for artwork purposes only.
 1sq.m. = 10.763 sq.ft.

Reference Area: 1960 sq. ft. 3BHK + 3T + SR + TERRACE
 Carpet Area: 1071.33 sq.ft. ~ 1074.23 sq. ft
 Balcony Area: 326.46 sq.ft.
 Tower B and A (1 and 4 Units)

Note: Visual representations shown in this brochure are purely conceptual. All building plans, specifications, layout plans etc. are tentative and subject to variation & modification by the company or the competent authorities sanctioning plans. Brand names appearing in the brochure are for artwork purposes only.
 1sq.m. = 10.763 sq.ft.

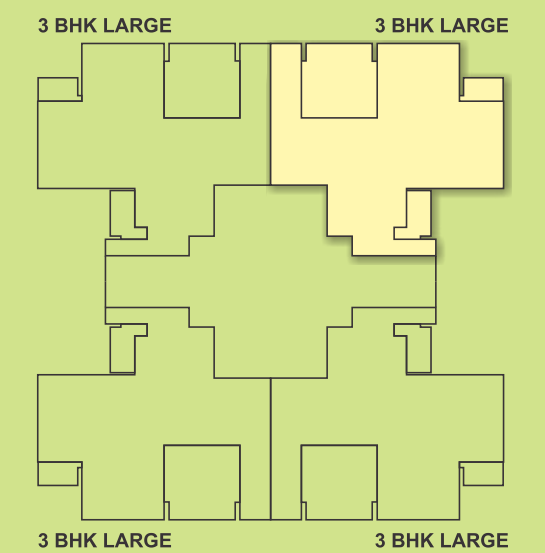

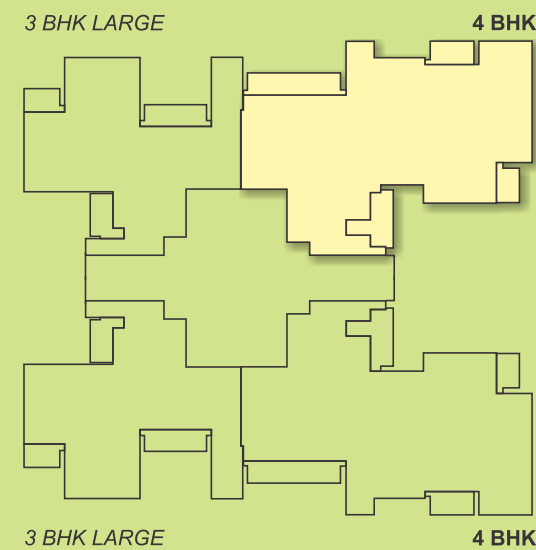

Reference Area: 2650 sq. ft. 4BHK + 4T + SR
 Carpet Area: 1687.99 sq.ft.
 Balcony Area: 276.74 sq.ft.
 Tower A (2 and 3 Units)

Note: Visual representations shown in this brochure are purely conceptual. All building plans, specifications, layout plans etc. are tentative and subject to variation & modification by the company or the competent authorities sanctioning plans. Brand names appearing in the brochure are for artwork purposes only.
 1sq.m. = 10.763 sq.ft.

Reference Area: 2710 sq. ft. 4BHK + 4T + SR + TERRACE
 Carpet Area: 1687.99 sq.ft.
 Balcony Area: 350.36 sq.ft.
 Tower A (2 and 3 Units)

Note: Visual representations shown in this brochure are purely conceptual. All building plans, specifications, layout plans etc. are tentative and subject to variation & modification by the company or the competent authorities sanctioning plans. Brand names appearing in the brochure are for artwork purposes only.
 1sq.m. = 10.763 sq.ft.

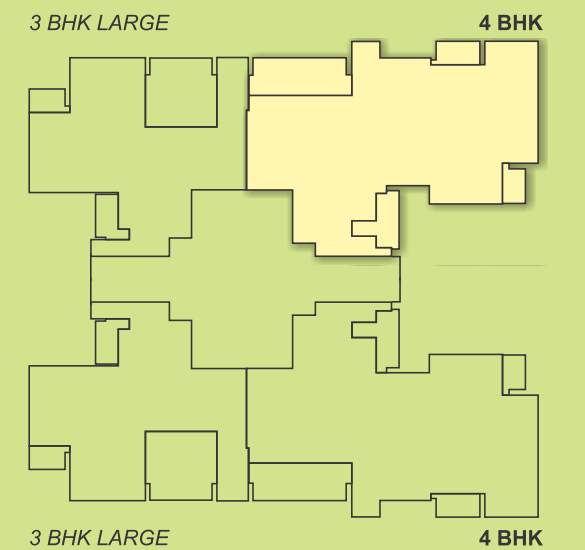



MAPSKO
Casa Bella
 Sector-82, Gurgaon

956 Units
 APARTMENTS | VILLAS
 PENTHOUSES



MAPSKO
Garden Estate
 Sector-26, 26A & 27 Sonapat

Approximately 150 Acres
 INTEGRATED TOWNSHIP



MAPSKO
Royale Ville
 Sector-82, Gurgaon

486 Units
 3-4-5 BHK LUXURY APARTMENTS



MAPSKO
cityhomes
 Sector-27, Sonapat

486 INDEPENDENT FLOORS
 180 / 250 / 350 sq.yards

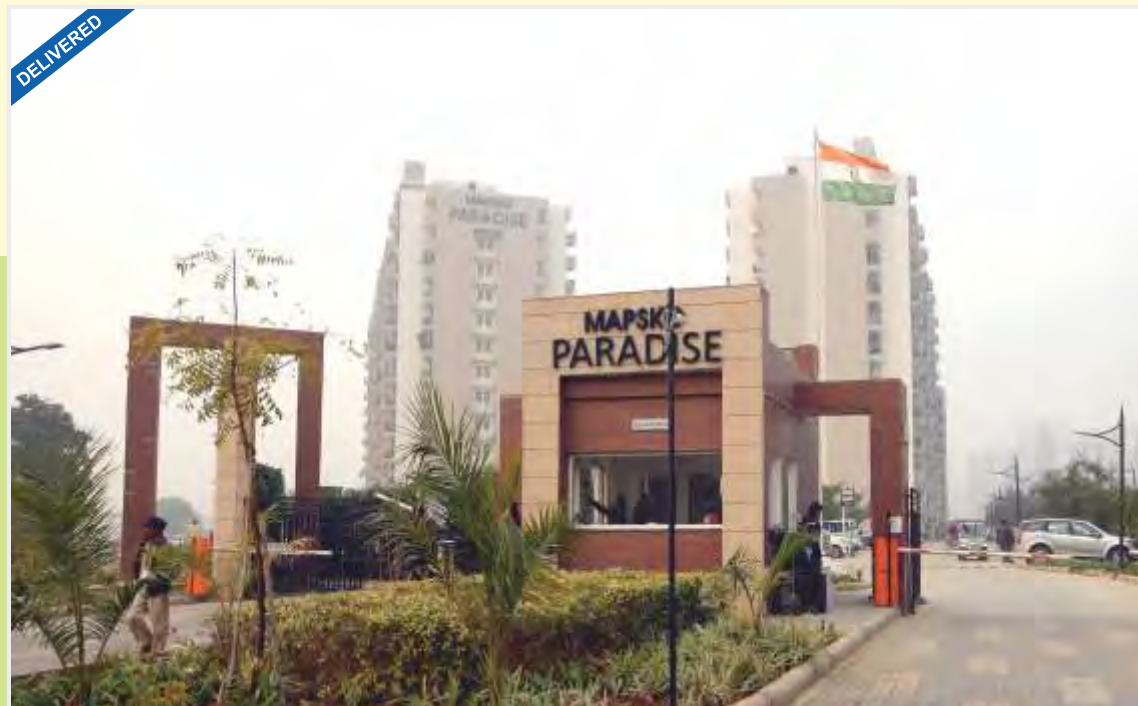

MAPSKO
Paradise
 Sector-82, Gurgaon

348 Units
 2-3 BHK APARTMENTS



MAPSKO
Galleria
 Sector-26, 26A & 27 Sonapat

HRERA registered PKL-SNP-72-2018 Dated: 14.12.2018
562 Shops
 COMMERCIAL SPACE

Few Prestigious Projects

Few Prestigious Projects



MAPSKO 
MOUNT VILLE
 SECTOR-79, GURGAON
 3-4 BHK Aravali View Premium Hill Homes

HRERA registered 328 of 2017 dated 23/10/2017

- 2 min drive from SPR
- 2 min drive from NH-8
- 5 min drive from Golf Course Extn. Road/Sohna Road

* Traveling time depending on traffic conditions
 * Indicative Map not to Scale

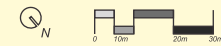

Location Map

Gurgaon - The city is icon of rapid development with presence of network of wide roads, expressways, highways and metro, and much in pipeline. Mount Ville at sector 79 is ideally located at the serene foothill of Aravali.